

South Cambridgeshire Hall
Cambourne Business Park
Cambourne
Cambridge
CB23 6EA

t: 08450 450 500
f: 01954 713149
dx: DX 729500 Cambridge 15
minicom: 01480 376743
www.scambs.gov.uk



3 July 2008

To: Chairman – Councillor
Members of the Electoral Arrangements Committee – Councillors NCF Bolitho,
RM Matthews, NJ Scarr, RT Summerfield, RJ Turner, Mrs BE Waters and
JF Williams

Quorum: 3

Dear Councillor

You are invited to attend the next meeting of **ELECTORAL ARRANGEMENTS COMMITTEE**, which **WILL NOW** be held in the **COUNCIL CHAMBER, FIRST FLOOR** at South Cambridgeshire Hall on **TUESDAY, 8 JULY 2008 at 7.30 p.m.**

Yours faithfully
GJ HARLOCK
Chief Executive

The Council is committed to improving, for all members of the community, access to its agendas and minutes. We try to take all circumstances into account but, if you have any specific needs, please let us know, and we will do what we can to help you.

AGENDA

7. **ARBURY PARK PARISH REVIEW**
To consider a report of the Principal Solicitor.

PAGES
1 - 18

GUIDANCE NOTES FOR VISITORS TO SOUTH CAMBRIDGESHIRE HALL

Whilst the District Council endeavours to ensure that you come to no harm when visiting South Cambridgeshire Hall you also have a responsibility to ensure that you do not risk your own or others' safety.

Security

Visitors should report to the main reception desk where they will be asked to sign a register. Visitors will be given a visitor's pass that must be worn at all times whilst in the building. Please remember to sign out and return your pass before you leave. The visitors' book is used as a register in cases of emergency and building evacuation.

Emergency and Evacuation

In the event of a fire you will hear a continuous alarm. Evacuate the building using the nearest escape route; from the Council Chamber or Mezzanine viewing gallery this would be via the staircase just outside the door. Go to the assembly point at the far side of the staff car park. Do not use the lifts to exit the building. If you are unable to negotiate stairs by yourself, the emergency staircase landings are provided with fire refuge areas, which afford protection for a minimum of 1.5 hours. Press the alarm button and wait for assistance from the Council fire wardens or the fire brigade. Do not re-enter the building until the officer in charge or the fire brigade confirms that it is safe to do so.

First Aid

If someone feels unwell or needs first aid, please alert a member of staff.

Access for People with Disabilities

All meeting rooms are accessible to wheelchair users. There are disabled toilet facilities on each floor of the building. Hearing loops and earphones are available from reception and can be used in all meeting rooms.

Toilets

Public toilets are available on each floor of the building next to the lift.

Recording of Business

Unless specifically authorised by resolution, no audio and / or visual or photographic recording in any format is allowed at any meeting of the Council, the executive (Cabinet), or any committee or sub-committee of the Council or the executive.

Banners / Placards / Etc.

No member of the public shall be allowed to bring into or display at any Council meeting any banner, placard, poster or other similar item. The Chairman may require any such item to be removed.

Disturbance by Public

If a member of the public interrupts proceedings, the Chairman will warn the person concerned. If they continue to interrupt, the Chairman will order their removal from the meeting room. If there is a general disturbance in any part of the meeting room open to the public, the Chairman may call for that part to be cleared.

Smoking

The Council operates a **NO SMOKING** policy.

Food and Drink

Vending machines and a water dispenser are available on the ground floor near the lifts. There shall be no food and drink in the Council Chamber.

Mobile Phones

Please ensure that your phone is set on silent / vibrate mode during meetings.

SOUTH CAMBRIDGESHIRE DISTRICT COUNCIL

REPORT TO:	Electoral Arrangements Committee	8th July 2008
AUTHOR/S:	Principal Solicitor	

ARBURY PARK PARISH REVIEW

Purpose

1. To receive an update from the Principal Solicitor on the responses to the consultation on the proposal of this Committee at its February meeting to create a new parish for the Arbury Park area.
2. To consider whether to make a final recommendation to Council on the creation of a new Parish at Arbury Park or otherwise.
3. To note the procedure for creation of a new parish and related actions.

Background

4. The section 106 Agreement completed in connection with the development at Arbury Park on the northern Cambridge fringe in June 2005 and to which the District Council is a party obliges the District Council to use its reasonable endeavours to arrange for an electoral review of the electoral area within the site pursuant to section 9 of the 1997 Act, section 13 of the Local Government Act 1992 or 'such other statutory provision as shall be deemed requisite for such purpose', arising from the additional electorate occupying the development. The trigger point for the review was reached in the summer of 2007 upon 100 electors first occupying the development.
5. There are approximately 245 occupied properties at Arbury Park with a substantial amount of development planned. This large development currently falls wholly within Impington and the Parish Council are experiencing a greatly increased workload as a result. They feel very strongly that a new parish will better serve the interests of the residents on the new development.
6. Officers consulted on the possible options for review last summer and the responses received and the issues raised by interested parties are set out fully in the October report to this Committee. Members will recall that clarification was sought on the timing of a possible City/District boundary review and the Committee decided in February, in light of the timescales given, to proceed with the parish review on the Cambridge Northern Fringe. The Committee resolved, in light of the guidance contained in Circular 11/97 and the consultation responses received, to propose that a new parish be established for the Arbury Park area and resolved to consult on this proposal. The Committee made a decision on the arrangements for securing that persons who may be interested in the proposal are informed of the proposals and the timescales within which representations could be made.
7. The parish review process is therefore at the stage where this Committee should take into consideration representations received on their proposal, and further consider whether they wish to make a final recommendation to Council on a review, now called a reorganisation order under new legislation referred to below. The Committee will

also have to consider the name and style of any new parish, whether there should be a parish council and also what the electoral arrangements will be for the new parish.

Process

8. This review commenced under the 1997 legislation and is being concluded under the Local Government and Public Involvement in Health Act 2007 ('the 2007 Act') and associated Regulations. New guidance on undertaking 'community governance reviews' was issued jointly by CLG and the Electoral Commission in April 2008 under section 100 of the 2007 Act ('the Guidance'). The introduction to the Guidance makes clear that the Secretary of State now has no involvement in decisions on parish reviews and the Electoral Commission's involvement is limited to giving effect to consequential recommendations for related alterations to the electoral areas of principal councils (in this case SCDC is the principal council).
9. This review is subject to the provisions of The Local Government and Public Involvement in Health Act 2007 (Commencement No.3, Transitional and Savings Provisions and Commencement No.2 (Amendment)) Order 2008 which states certain specified sections of the 1997 Act shall continue to have effect where reviews have been commenced under that Act but were not concluded when the 2007 Act came into force. The Order substitutes certain sections of the 1997 Act. The decision made at the February meeting of this Committee was just in advance of these transitional regulations being published on 12th February 2008. However, they do assist in clarifying the point at which the new legislation takes effect in this review by reference to the point reached in the process under the 1997 Act. This Council was only part way through the stage set out in section 10 of the 1997 Act. The Principal Solicitor's advice is that paragraph 5 of the Order applies insofar as this Committee has made draft recommendations. Therefore sections 9, 18, 22 and 24 of the 1997 Act shall continue to have effect until this Committee makes final recommendations to Council.
10. If and when final recommendations are made they shall be treated as recommendations made in a community governance review under Part 4 of the 2007 Act and sections 86, and 96 to 100 of that Act shall apply. Section 86 of the 2007 Act requires a community governance review to recommend either to create a new parish or not, and sets out the different ways that such an area can be created. If the review recommends the constitution of a new parish, it must also make recommendations as to the geographical name of that area, whether the parish should be known by an alternative style and recommendations as to whether or not there should be a parish council. Section 96 to 100 deals with publicising the outcome of the review and supplementary and incidental matters. A decision to create a new parish from part of an existing parish is known as a reorganisation order. In addition, the Council needs to make a decision on electoral arrangements for any new parish and consider whether any changes are required to any existing parish affected by the reorganisation order.
11. The Local Government (Parishes and Parish Councils) (England) Regulations 2008 and the Local Government Finance (New Parishes) (England) Regulations 2008 deal with incidental and transitional matters such as the distribution of property, rights and liabilities of parish councils affected by a reorganisation order.
12. At the time of writing this report CLG and the Electoral Commission have not yet produced the model reorganisation order which was to have been made available on commencement of the relevant provisions of the new Act. It is hoped this will be available shortly.

Considerations

13. There is an obligation on this authority to have regard to the Guidance. The following sections of the Guidance are relevant when considering the representations which have been received:
- 'When undertaking the review, Principal Councils must have regard to the need to secure that community governance reflects the identities and interests of the community in the area under review, and the need to secure that community governance in that area is effective and convenient.'
 - 'As stated in the Local Government White Paper parish councils are an established and valued form of neighbourhood democracy and management. They are not only important in rural areas but increasingly have a role to play in urban areas. We propose to build on the existing parish structure, so as to improve its capacity to deliver better services and represent the community's interests.'
 - 'Parish councils continue to have two main roles: community representation and local administration. For both purposes it is desirable that a parish should reflect a distinctive and recognisable community of place, with its own sense of identity. The views of local communities and inhabitants are of central importance.'
 - 'Parish councils have an important role to play in the development of their local communities. Local communities range in size, as well as in a variety of other ways. Communities and Local Government is working to help people and local agencies create cohesive, attractive and economically vibrant local communities. The aim for communities across the country is for them to be capable of fulfilling their own potential and overcoming their own difficulties, including community conflict, extremism, deprivation and disadvantage. Communities need to be empowered to respond to challenging economic, social, and cultural trends, and to demographic change.'
 - 'It is clear that how people perceive where they live - their neighbourhoods - is significant in considering the identities and interests of local communities and depends on a range of circumstances, often best defined by local residents. Some of the factors which help define neighbourhoods are: the geography of an area, the make-up of the local community, sense of identity, and whether people live in a rural, suburban, or urban areas.'

Consultation on the proposal to create a new parish at Arbury Park

14. A spreadsheet containing the responses received is attached (Appendix 1). A leaflet containing a plan was delivered to all residents in Impington, Histon, Girton and Milton and posters were distributed locally advertising the community event held on 30th April 2008. The response to the leaflets has been good. The level of attendance at the event was disappointing but those Arbury Park residents who attended were very keen to have a new parish established as soon as possible. Two City Councillors attended and one local Member. A copy of the leaflet is attached (Appendix 2).
15. Members will note the following from the attached spreadsheet (the City Council's comments are shown in blue):
- There were 49 responses in total (joint responses have been calculated as two)

- 28 respondents express a preference for Arbury Park to become a new parish. Some of these respondents live in Arbury and some in Impington north of the A14 and neighbouring parishes.
 - 6 respondents feel this whole process is premature pending a possible district/city boundary review
 - Of those 6, one is the City Council and 3 are City Councillors: in their view if SCDC is going to pursue the review then the area for the new parish should include Kings Meadows estate. (One of the 3 City Councillors stated that it should include other areas in north Cambridge but reiterated that to go ahead now is an unnecessarily bureaucratic procedure. Clearly it is not possible to consider areas of the City for inclusion in a parish.)
 - 4 respondents suggest that all of Impington south of the A14 should become a new parish. Members will recall that such an option was the subject of the review consultation last summer and was not supported.
 - 1 respondent suggests that the new parish should be formed of Arbury, Kings Meadows and Cambridge Regional College AND be part of the City.
 - 1 respondent would like to see a unitary authority brought into existence
 - 1 response was unclear
 - 8 respondents felt that the new parish should include Kings Meadows estate as well as Arbury because of the similar urban nature and the fact that both areas are isolated from Impington by the A14 barrier. These respondents include the County Councillor for the area concerned and a City Councillor.
16. A further representation was received from the Arbury Park Residents' Group who undertook a door-to-door survey of residents living at Arbury. They distributed 150 questionnaires to 70% of the houses and received a response rate of 30%. (It is not known how many of the respondents to this survey also responded to the leaflets distributed by the Council.) Of those that responded 89% agreed to a new parish at Arbury being formed. Further questions in the survey concerned the name of a new parish. This is dealt with later in the report.
17. Milton Parish Council and Impington Parish Council agree with the proposal. The Chairman of Girton Parish Council has expressed his agreement with the proposal.
18. Members may wish to consider whether in light of the responses they wish to re-visit the recommendation on the creation of a new parish for Arbury. The City Council is clearly concerned about community cohesion, and the impact of not including Kings Meadows, were the city/district boundary to be moved to include Arbury Park and Kings Meadows within the City. However, the issue of parishes moving into the City boundary will be universal should there be a review of the city/district boundary because all of the affected communities are parished. The Committee must have regard to the CLG Guidance referred to above in considering the different communities. Many of those calling for a parish for Arbury alone are residents of Arbury. There have been no representations from the residents of Kings Meadows estate as far as the Principal Solicitor is aware.

Name and style of any new parish

19. Section 4 of the Guidance deals with Parish names and alternative styles for parishes. Paragraphs 107 and 110 state:
20. "The 'name' of a parish refers to the geographical name of the area concerned, whereas its status or 'style' allows for that area to be known as a town, community, neighbourhood or village, rather than as a parish. The status or style of the parish will

be reflected in the name of any council of the parish, the parish meeting, any parish trustees, and the chairman or vice-chairman of the parish meeting or of any parish council. So, for example, the council of a parish which uses the style 'village' will be known as the 'village council' and its councillors as the 'village councillors', etc."

21. "Where the review relates to a new parish, it is for the principal council, in the first instance, to make recommendations as to the geographical name of the new parish, and as to whether or not it should have one of the alternative styles. So far as existing parishes under review by principal councils are concerned, the review must make recommendations as to whether the geographical name of the parish should be changed, but it may not make any recommendations for the parish about alternative style. It will be for the parish council or parish meeting to resolve whether the parish should have one of the alternative styles."
22. The previous reports to this Committee have not addressed this issue. The Committee will need to consider this point should it decide to make a recommendation to Council on a reorganisation order. The Committee may wish to note the Arbury Residents Group consultation on the name and style of a parish for Arbury Park. They have suggested the name 'Orchard Park Community Council'.

Electoral Arrangements

23. Electoral Arrangements for any new parish will need to be considered under the following headings: the year in which ordinary elections of parish councillors are to be held; council size – the number of councillors to be elected to the council; and parish warding – whether the parish should be divided into wards for the purpose of electing councillors. Consideration will also have to be given to any changes to the electoral arrangements for Impington Parish Council and Milton Parish Council should a new parish council for Arbury Park as proposed be recommended to Council. Whilst the Council can confirm the creation of a new parish and the electoral arrangements for the new parish, the Council will need to make recommendations to the Electoral Commission on any consequential changes that may be required to electoral areas of the Council. The Council is required to consult on the electoral arrangements. Further guidance is being sought from the Electoral Commission and CLG and this will be reported to Members at the Committee meeting.
24. The Guidance indicates that for administrative and financial purposes (such as setting up the parish council and arranging its first precept), the order should ordinarily take effect on the 1 April following the date on which it is made. Electoral arrangements for a new or existing parish council will come into force at the first elections to the parish council following the reorganisation order. However, where a new parish is to be created, if the next elections to the ward or division are not scheduled to take place for some time, the principal council is able to modify or exclude the application of sections 16(3) and 90 of the Local Government Act 1972 to provide for the first election to the parish council to be held in an earlier year, with councillors serving a shortened first term to allow the parish council's electoral cycle to return to that of the district ward. If the Committee were minded to recommend that a new parish for Arbury Park be created then discussions on electoral arrangements will be held with Impington Parish Council.
25. The following extracts in quotes are taken directly from the Guidance in relation to aspects of electoral arrangements:

"In considering the issue of council size, the (Electoral) Commission is of the view that each area should be considered on its own merits, having regard to its

population, geography and the pattern of communities. Nevertheless, having regard to the current powers of parish councils, it should consider the broad pattern of existing council sizes. This pattern appears to have stood the test of time and, in the absence of evidence to the contrary, to have provided for effective and convenient local government." Based on current practice within the district should a new parish be created then its final numbers of Councillors would be between 9 and 11.

26. "There is likely to be a stronger case for the warding of urban parishes, unless they have particularly low electorates or are based on a particular locality. In urban areas community identity tends to focus on a locality, whether this be a housing estate, a shopping centre or community facilities. Each locality is likely to have its own sense of identity. Again, principal councils should consider each case on its merits having regard to information and evidence generated during the review." If the committee were to propose a new parish for the Arbury Park area it is not thought that warding of an area of that size would be necessary.

23.

Financial	None
Legal	None
Staffing	None
Risk Management	None
Equal Opportunities	None

Effect on Annual Priorities and Corporate Objectives

24.

Working in partnership to manage growth to benefit everyone in South Cambridgeshire now and in the future	The consultation involved in the parish/community governance review process shows partnership working to manage growth for the benefit of local residents in the affected areas.
Deliver high quality services that represent best value and are accessible to all our community	The review acknowledges the need to meet the changing requirements of our communities.
Enhance quality of life and build a sustainable South Cambridgeshire where everyone is proud to live and work	The review takes account of providing best local governance arrangements for residents.

Recommendations

25.

- i) That, having regard to the legislation, the Guidance and all of the representations received in response to the notice given on the proposal that a new parish be created for Arbury Park that the Committee consider making a final recommendation to Council asking Council to make a reorganisation order creating a new parish at Arbury Park and a Parish Council and amending the parish boundaries of Impington Parish and Milton Parish, by reference to a plan of the proposed changes;

- ii) If the Committee so resolve they should also indicate to Council whether they wish to recommend a name and style for the new parish;
- iii) That the Committee consider, if appropriate, what electoral arrangements will apply to that Parish Council and the requirement for any amended electoral arrangements for Impington Parish Council and Milton Parish Council, which will form the basis for consultation and subsequent consideration by Council.

Background Papers: the following background papers were used in the preparation of this report:

The October and February reports to the Electoral Arrangements Committee
Local Government and Public Involvement in Health Act 2007
Local Government and Public Involvement in Health Act 2007 (Commencement No.3, Transitional and Savings Provisions and Commencement No.2(Amendment)) Order 2008
Local Government and Rating Act 1997
Environment Circular 11/97
CLG/Electoral Commission 'Guidance on community governance reviews' April 2008
The Local Government (Parishes and Parish Councils) (England) Regulations 2008
The Local Government Finance (New Parishes) (England) Regulations 2008
Representations from interested parties

Contact Officer: Catriona Dunnett, Principal Solicitor
 Telephone: (01954) 713308

This page is left blank intentionally.

NEW PARISH - ARBURY PARK		A = Arbury
Comments		K= Kings Meadows
It would have been helpful to have had some information about rateable values/council tax to help make a judgement. Without this additional information as far as boundaries are concerned, there seems no logic in retaining any of Impington Parish South of the A14: The A14 is a barrier to community feeling.		A+K+
Am in total agreement with the proposal. Also agree to the CRC campus being contained within Milton Parish. Thinks the new parish should be created now.		A
Given that the development of Arbury Park is still underway it is premature to consider forming a new parish there. If the proposal does go ahead it is vital for community cohesion that Kings Meadow residents are included in any new parish and are not left behind. Arbury Park and Kings Meadow have links with each other (some RSL tenants have transferred across to Arbury Park). Both communities have strong natural links with the City as recognised in the wider boundary review likely to eventually see both coming into the City boundaries.		A+K
I am a Milton resident. I think it would be a good idea for Arbury Park to have its own parish council.		A
I confirm my support for a separate parish council for Arbury Park.		A
We feel that Arbury Park should become a parish of its own. We live in Impington and feel that we have little in common with the new residents of Arbury Parish which is very much an urban development and part of Cambridge City rather than part of our village, especially with the A14 as such an impassable barrier between "old" Impington and Arbury Park. Same feelings apply to the Meadows Estate. Both of these areas are geographically and spiritually part of Cambridge City North, not Impington.		A x 2
The A14 now provides an obvious boundary between the City and the county. I cannot believe that there is anybody living in Kings Meadow or Arbury Camps who doesn't consider themselves a city dweller with no connection with Histon or Impington; or that anybody in Histon or Impington feels any connection with Kings Meadow or Arbury Camps. Why cannot any new parish encompass Kings Meadow, Arbury Camps and CRC and be part of the City of Cambridge		A+K/ City
I agree that Arbury Park should be in a new parish and not part of Impington. I also feel that this new parish should consist of all areas in Impington parish south of the A14 as otherwise the Kings Meadow development would be fairly detached from Impington.		A+K+

Arbury Park will, by its nature and in common with similar developments, settle into a slum area and crime hotspot with no similarities to either Impington or Milton. These latter parishes should be left to concentrate on their own governance. CRC should become part of Milton parish. The area of Impington parish within the corner formed by Histon Road and Kings Hedges Road should be transferred to the Arbury Park parish, this area being within the Impington parish is an anachronism and makes no sense. These changes will upset Impington parish but they should be grateful for the opportunity to avoid the inevitable problems with Arbury Park.	A+K?
I agree with SCDC's proposal to create a new parish and council for Arbury Park. It is more appropriate for Arbury Park to have its own parish council. Separate response received: I support the idea of forming a new parish council now for Arbury Park.	A
I approve of the plan to form a new parish at Arbury Park.	A
I support the creation of a new parish and parish council for Arbury Park, at the earliest possible instance. The 2006 Government White Paper is wholeheartedly in support of the creation of new parishes and contains a presumption of creation. The City/SCDC review is an independent issue - and the City may be parished by the time it happens anyway.	A
I'd like to record my wholehearted support for the proposals to create a new Parish for Arbury Park, and a new Parish Council as soon as possible.	A
Do not see the point of the creation of a new parish at this time when boundary reviews are under action consideration. I do not know when this is likely to take effect, but there are no parish councils currently in Cambridge and the existence of just one would cause serious anomalies, not least since Cambridge already has area committees. So does SCDC actually want to do something like this even though it will not fit in the future, or is it expected that the parish council will abolish itself, or be abolished from above, when boundaries are redrawn? Or is Histon and Impington feeling so overwhelmed that they must be rid of Arbury Park asap? There seems to be an overwhelming case for not taking precipitate action.	Prem.
I am in agreement with your newsletter received today, that having a separate parish for Arbury Park is the best option. As a resident of Impington for the last 25 years, I feel that we have little in common with the new development and think that we would both be served best by being independent.	A
CRC should be in one Parish or the other, not split. I do not believe that Arbury Park should be part of the Impington Parish, it is too disjointed from the village life in Impington. I am also not sure if it should be in its own Parish either, due to the overheads a standalone parish brings. Has it been considered to merge Arbury Park with Kings Hedges? If it is not logical to merge Kings Hedges and Arbury Park, then yes make Arbury Park its own Parish.	A/A+K

	<p>Thoroughly agree that Arbury Park should be a new parish, but fail to see why the area of Impington to the south of Arbury Road and to the east of Cambridge Road has not been included in the new parish and certainly not logically part of the predominantly rural parish of Impington. The whole of the area to the south of the A14 and to the east of Cambridge Road should become part of Cambridge City Council and not be part of SDCDC.</p>	A+K	
	<p>We agree that it makes sense for Arbury Park to be a separate parish from Histon/Impington. It is part of the city of Cambridge, has a more urban flavour and its position the other side of the A14 means that its locationally disparate too. However, I cannot see why the part of Cambridge on the same side of Cambridge Road is not also part of that new parish. It too has an urban flavour.</p>	A+K	
	<p>I applaud the proposed new parish of Arbury Park. The needs of a new estate are completely different from an established rural village, and the administration needs to reflect these differences. However, I feel that to place a few roads up the B1049 into Impington is quite ludicrous. They have no physical connection with the village and they have far more in common with the rest of the S Arbury estate. The most logical change of boundary is to keep Impington to the area north of the A14. This preserves the integrity of the village and makes administration simpler and more logical.</p>	A+K+	
	<p>I strongly support your proposal for a new separate parish council for Arbury Park for all the reasons given. It is a new community where none existed before. It would be good to have a newly created council in place to focus and direct the developing identity that a council would give to the growing community. It seems logical that in time the city's boundary will be extended to the A14 and Arbury Park could then be assimilated to the city's structure.</p>	A	
	<p>The A14 is a new natural boundary for the City of Cambridge so why don't we wait until future district boundary changes takes place?</p>	Prem.	
	<p>I would like to offer my support for the proposed changes to Parish Council boundaries and the formation of a new Parish Council for Arbury Park. I live in Impington (Percheron Close) and own a business with 20 staff, also operating in Histon.</p>	A	
	<p>Kings Meadow should be included. The Parish Council should be representative of all residents. Before a Parish Council is created I would want to see consultation with all residents in the parish. Please clarify how the Parish Council could persist if the boundary changes and the area became part of the City?</p>	A+K	
	<p>Makes sense to have a separate parish for Arbury Park. No objections to the proposed changes.</p>	A	

<p>While I entirely agree that Impington Parish Council has no logical connection with the new development on Arbury Camp by that same logic it has no connection with the Kings Meadow estate either. I don't see how you can justify separating one and retaining the other. Granted, the connection between the two estates is a little tenuous but at least they do share a border and aren't divided by the A14. I am anxious that this does not set a precedent in the negotiations over the city boundary review. There are currently no parish councils in the city, nor are there any plans to create any. Whether Arbury Camp stayed as a parish if it moved into the city is not an issue I'd care to give any assurances on one way or the other. Certainly it isn't a populous enough area to be a single ward of the city on its own. Given that, I really hesitate to say that creating the parish now is a good idea; if the timescales for a boundary review are as short as seem likely, you could simply end up throwing away the money invested in the democratic infrastructure.</p>	<p>Prem. But A+K</p>
<p>Motion: a) To support SCDC proposals for creation of a new parish to cover Arbury Park as per their published map; that creation to be as soon as practicable. B) That Impington PC "ringfences" that element of the precept from residents in Arbury Park less any attributable expenditure, to be transferred to the new Parish Council upon creation.</p>	<p>A</p>
<p>I believe that to create a new parish for Arbury Park would be a good idea. Although Impington have done a tremendous job, I feel that its time that AP were able to have its own council which could serve the interests of the residents 100%. Although I realise a potential new parish would be short lived, with AP probably being brought into Cambridge City control in the future, I feel that if we are to grow as a community, a new parish would be hugely beneficial to the growth of the development.</p>	<p>A</p>
<p>Submits support for an independent Arbury Park Parish Council.</p>	<p>A</p>
<p>I am 110% in favour of an Arbury Park parish. It is important and sensible because it gives local residents control of their own decision making; it hugely simplifies the financial arrangements in place between Histon, Impington and Arbury Park; it will significantly reduce the now inappropriate burden on Impington Parish Council and it recognises the huge and unsustainable cultural differences between the established village of Impington and the new urban community of Arbury Park</p>	<p>A</p>
<p>Please keep Arbury Park separate from Histon and Impington. This ugly development has nothing in common with our villages so should be treated as a separate area.</p>	<p>A</p>
<p>As a member of Histon parish all is excellent. Why does the boundar dip to the right angle into Minerva Way? Is there a councillor who prefers to be in the new parish?</p>	<p>?</p>

As residents of Impington Village we would support the creation of a new parish for Arbury Park. This is not a case of trying to 'get rid of them' but of creating a body that can properly serve their needs since these are so distinct from our own.	A x 2	
[<i>very lengthy email but in summary</i>] I am of the opinion that Arbury Park should be new parish on its own.	A	
This consultation is misconceived. The whole of the area south of the A14 should, in fact, be transferred to Cambridge City. The major part of South Cambs should be similarly transferred so that Cambridge can become a unitary authority similar in size to Peterborough. It could encompass new towns like Northstowe and Cambourne and settlements out to Bottisham and some of the Swaffhams. That would leave a rural area of England, parts of East Cambs and Huntingdon to be a rural unitary, perhaps centred on Ely.	Unitary	
This review and recommendation is premature at best. The statement that "Kings Meadow development ... Is not affected by the growth at Arbury Park" is misguided. The entire area is affected by the development, including as far as the East and West Chesterton and Castle wards, as well as the obvious impact on both Arbury and King's Hedges wards. Should the creation of the parish proceed, I feel it is imperative that the proposal must include at a minimum the Meadows and with the utmost effort, the area to be created in relation to the review mentioned above. Ideally, unless the County Council wish to forward the impression that it thrives on the creation and fostering of unnecessary bureaucratic procedures as a temporary measure, this consultation should be placed on hold until the completion of the boundary review above.	Prem. But A+K+	
[<i>very lengthy email but in summary</i>] in support of Arbury Park being a separate parish. Comments basically relate to facilities in Impington being used by those on the Arbury Park development etc.	A x 2	
In view of the fact that the boundary between South Cambridgeshire and Cambridge City is currently under discussion, it is not clear to my why this process has been initiated now. It seems, to say the least, premature. Secondly, should a new parish be created, I disagree with the idea that the Meadows Estate should remain in Impington Parish. The Meadows is directly adjacent to the Arbury Park but slightly further from Impington and both areas are isolated from the remainder of Impington by the A14. In practical terms just like Arbury Park, the Meadows is an extension of the Cambridge urban fringe, with two or three road exits lying inside the city boundary. The Meadow Estate's status within Impington parish is anomalous in exactly the same way as Arbury Park and there appears to be no sensible reason for a parish review to treat the two separately.	Prem. But A+K	
Supports Impington Parish Council in its belief that the new Arbury Park parish should be created now, based on the reasoning given in the consultation document.	A	

<p>My view is that all of Arbury Park should be taken out of Impington. It has different issues to Impington and needs to be dealt with as a separate parish. Additionally, Arbury Park is already getting a bad name for itself due to the local crime and I suspect the crime will increase due to its proximity to Kings Hedges and Arbury. Lets not have the name of the original area of Impington, and possibly the value of our houses going down, which could occur if Arbury Park is part of Impington.</p>	<p>A</p>
<p>Expresses approval of the proposal to create a new parish for Arbury Park.</p>	<p>A</p>
<p>The new Arbury Park development should not be part of the Impington Parish. However, the boundary changes need to go further. It would be far better if the Impington Parish no longer extended south of the A14. The proposed Arbury Park Parish could be extended to incorporate this land.</p>	<p>A+K+</p>
<p>I fully endorse the creation of a new parish for Arbury Park - it should be created now.</p>	<p>A</p>
<p>Urge deferral pending broader review of boundaries between City and District. The proposals if implemented would result in the main areas under consideration being brought into the City. It makes sense for any parish review to be based on revised boundaries rather than on present historic boundary. If the parish review goes ahead now you risk setting up parish arrangements that will need further review and amendment in light of revised boundaries. If SCDC feels compelled to press on, the review should anticipate the proposed boundary changes and create a parish that includes the Kings Meadows Estate as well as Arbury Park development. It does not make administrative sense to create a new parish based on the Arbury Park development whilst leaving Kings Meadows Estate as part of Impington. If the City District boundary is moved the Kings Meadows Estate will not remain part of Impington Parish Council. If it were to remain parished then there would be a need either for a new parish or for a belated merger with Arbury Park. It makes much more sense to include Kings Meadows Estate with Arbury Park now rather than later. Secondly we believe there are strong arguments</p>	<p>Prem.But A+K</p>
<p>in terms of community identity and cohesion in basing a new parish on Kings Meadows as well as Arbury Park. More account needs to be taken of the community of interest between Arbury Park and Kings Meadows Estate both represent growth of the urban fringe of Cambridge both are Cambridge facing they are in close proximity and are likely to share community facilities. Both are separated from Impington by the significant barrier of the A14.</p>	
<p>We agree it makes sense for Arbury Park to be a separate parish from Impington. It is part of the City, has a more urban flavour and is locationally disparate to. Cannot see why part of Cambridge on the same side of Cambridge Road is not also part of that new parish. It too has an urban flavour.</p>	<p>A+K x2</p>

<p>I am all in favour of Arbury Park being its own parish. As a new community our needs are different from those of individuals living in Impington and Milton. I believe we need to hold builders accountable and responsible for the area they are developing until it is fully lived in and has been turned over to the Council. I am a homeowner in Arbury.</p>	A	
---	---	--

This page is left blank intentionally.

A new parish for Arbury Park?

Have your say!



South
Cambridgeshire
District Council

Consultation from now to 18 April 2008

The story so far:

Over the summer and autumn of 2007 we looked at options for changing the boundaries of Impington parish in the light of the large number of new homes being built at Arbury Park.

After listening to the views of parish councillors and of residents from Impington and Arbury Park, our Electoral Arrangements Committee recommended we create a new parish for the Arbury Park development.

The new parish of Arbury Park – where?

The proposal is to take all of Arbury Park out of Impington parish to form a new parish, with its own parish council.

If you look at the map on the back of this page, you'll see that the current boundary between Impington and Milton cuts the Cambridge Regional College campus in two. We'd also like to sort this out, so that the whole campus is in Milton parish. The Kings Meadow development, however, would remain part of Impington parish as this is not affected by the growth at Arbury Park.

Why make changes at all?

Residents have told us that Impington and Arbury Park are very different communities with distinct needs. With the growth of Arbury Park, it's felt that current parish arrangements do not properly represent both.

Is this new parish a good idea at the moment?

Some local residents, as well as parish and district councillors, have told us that a new parish with its own new parish council for Arbury Park will :

- allow councillors to focus solely on Arbury Park
- give residents a real say in influencing the future development of the area
- be best placed to influence decisions on community facilities
- decide allocation of resources in the community and set the parish element of the Council Tax
- reflect the identity and interests of the developing Arbury Park community

Also, Cambridge City Council and other parishes gave us their views on possible future adjustments to the boundaries between the city and South Cambridgeshire district. Although perhaps some time off, we should bear in mind that any future boundary changes will likely impact on the new parish.

Send us your views



We would like your views on:

- the creation of a new parish with the boundaries you see on the map overleaf
- whether the new parish should be created now, given the possible future district boundary changes

Comments are welcome between now and Friday 18 April 2008.

- online at www.scambs.gov.uk by following the links to 'parish review'
- by email at parishreview@scambs.gov.uk
- write to us at Parish Boundary Review, Community Services, South Cambridgeshire District Council, Cambourne Business Park, Cambourne, Cambridge CB23 6EA

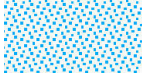
Key

-  Impington parish
-  Milton parish (including proposed parish boundary change)
-  New parish at Arbury Park
-  Current Impington/Milton boundary line

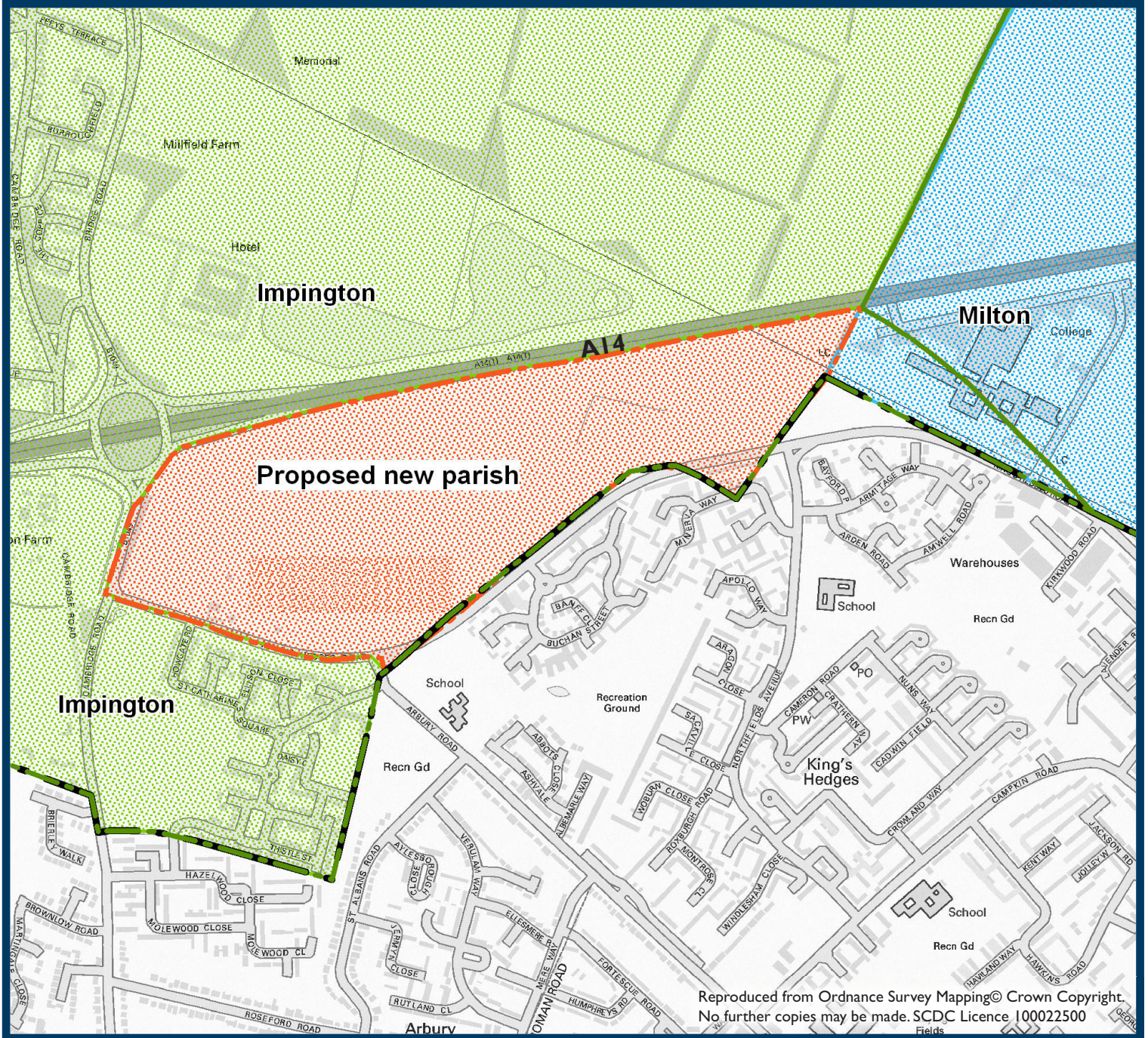

If you would like information in another language or in large print, please contact 08450 450500

যদি আপনি এই ডকুমেন্ট অন্য ভাষায় বা ফরমেটে চান অথবা যদি আপনার একজন ইন্টারপ্রেটারের প্রয়োজন হয়, তাহলে দয়া করে আমাদের সাথে যোগাযোগ করুন।

本文件可以翻譯為另一語文版本，或製作成另一格式，如有此需要，或需要傳譯員的協助，請與我們聯絡。

Jeżeli chciałby Państwo otrzymać ten dokument w innym języku lub w innym formacie albo jeżeli potrzebna jest pomoc tłumacza, to prosimy o kontakt z nami.

Se gostaria de ter este documento noutr idioma ou formato, ou se necessita de um intérprete, contacte-nos.

Если вы хотели бы получить этот документ на другом языке или в другом формате, или если вам необходимо воспользоваться услугами переводчика, просим обращаться в администрацию.

Bu belgenin Türkçe'sini edinmek ya da Türkçe bilen birisinin size yardımcı olmasını istiyorsanız, bize başvurabilirsiniz.

اگر این مدرک را به زبانی دیگر یا در فرمتی دیگر می‌خواهید یا اگر احتیاج به سرویس مترجم دارید، لطفاً با ما تماس بگیرید